

## Model: Inspiration® 29

### Overall Dimensions

With controls at the front

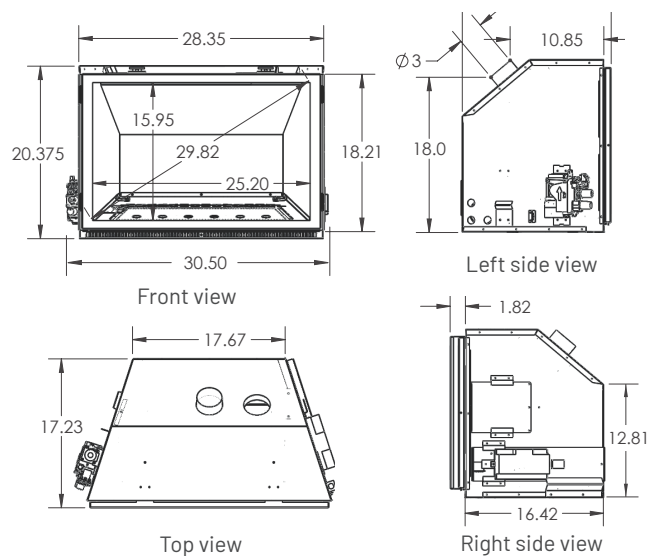

With controls at the back

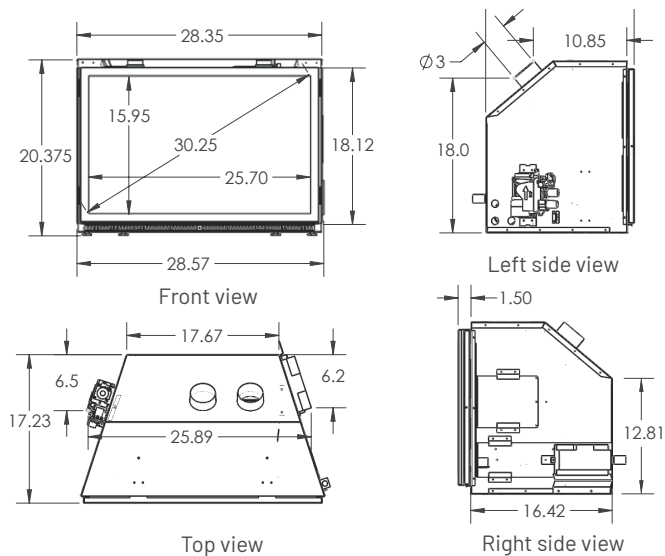

### Specifications

BTU INPUT				EFFICIENCIES			VENTING			GLASS		
NG Max	LP Max	NG Low	LP Low	Energuide	Steady State		Type	Max. Height	ID & OD	Type	Dimensions	Area sq in
31,500	29,500	17,500	15,000	NG 71.4% LP 72.3%	NG 79% LP 79%		Flex	40 feet	3" ID	Pure vision Robax	25.75" x 16"	410

	DIMENSIONS			MINIMUM FIREPLACE OPENING			VENTILATION		GESTION DES FLAMMES		
	Height	Depth	Width	Height	Depth	Width	Type	CFM	Valve type	Thermostat	Turn Down
Control back	20"	17.25"	28.5625"	20"	18"	28.75"	Variable speed	125	IPI	Remote control	NG 45% LP 50%
Control front	20"	17.25"	30.5"	20"	18"	30.75"	Variable speed	125	IPI	Remote control	NG 45% LP 50%

## Model: Inspiration® 29

### Minimum Opening Dimensions

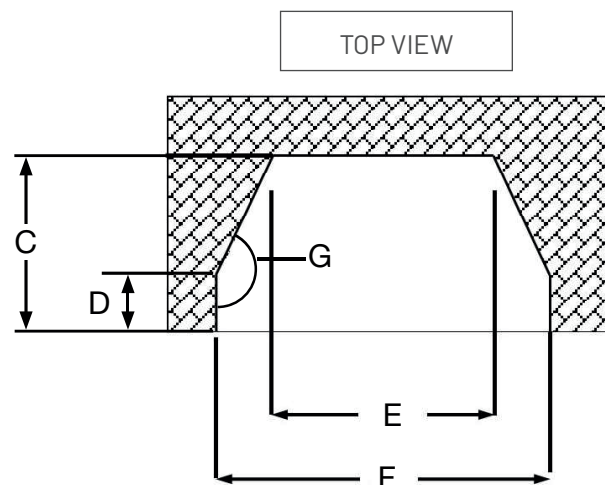
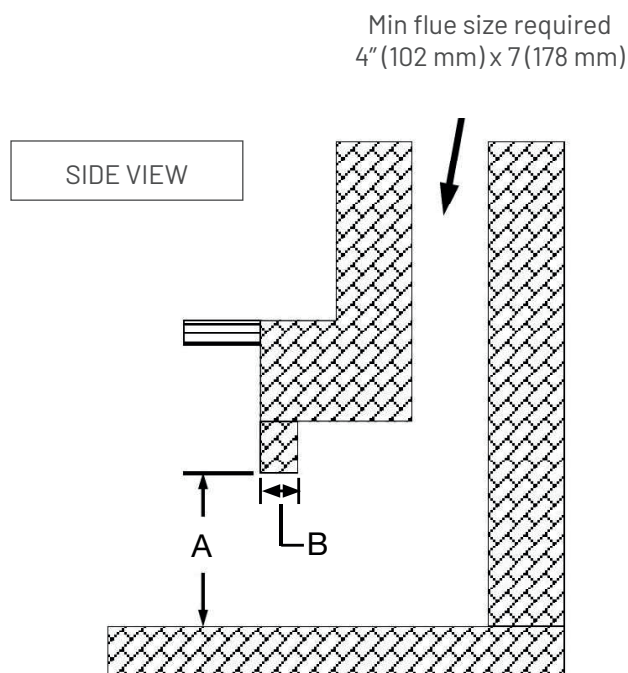

**WARNING :** Failure to position the parts in accordance with these diagrams or failure to use only parts specifically approved with this appliance may result in property damage or personal injury.

Reference	Dimensions	
	Controls Forward	Controls Rear
A	20" (508 mm)	20" (508 mm)
B	11,4" (289,6 mm)	11,4" (289,6 mm)
C	18" (457,2 mm)	18" (457,2 mm)
D*	5 - 10,5" (127 - 266,7 mm)	5 - 11,75" (127 - 298,5 mm)
E*	22,375 - 18" (568,3 - 457,2 mm)	22,375 - 18,625" (568,3 - 473,08 mm)
F*	30,75 - 31,5" (781,1 - 800,1 mm)	30,75 - 29,625" (781,1 - 752,48 mm)
G*	108° - 132°	108° - 131°

\* Dimensions must fit within stated limits. If a more narrow E is required, other dimensions (D, F and G) will change.

The installer must mechanically attach the marking supplied with the gas fireplace insert to the inside of the firebox of the fireplace into which the gas fireplace insert is installed.



## Model: Inspiration® 29

### Refacing an existing wood fireplace

#### Using Steel Studs and Cement Board on Wood Fireplaces

Brick or rock facing may be removed and replaced with noncombustible material such as steel studs and cement board.

**Warning :** Only facing material may be removed. All other masonry material must not be cut out, chipped away, or removed.

**Warning :** Louvers or any air circulation around existing solid fuel fireplace must not be blocked or covered.

The area between the masonry and the cement board must be sealed so that no heat can enter the open space between the masonry of the wood fireplace and the refacing material. **The insert must be moved outward so that the face of the fireplace is flush with the finishing material.**

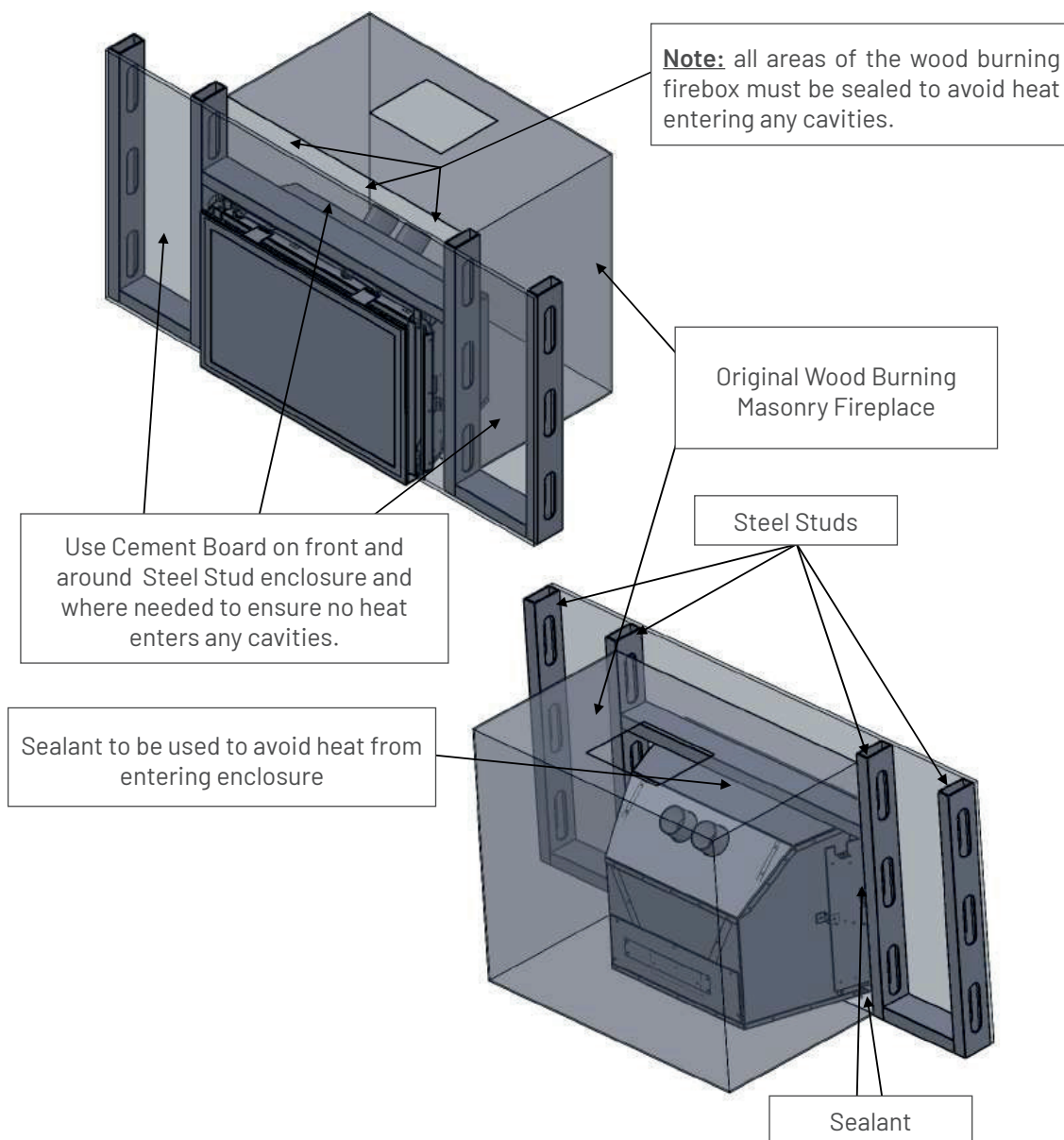



**AMBIANCE®**  
FIREPLACES | GRILLS

**Inspiration®**  
GAS COLLECTION

## Model: Inspiration® 29

### Mantel Clearances

Mantel clearances are measured from the top of the appliance door. Ensure combustible material is not placed within the area shown.

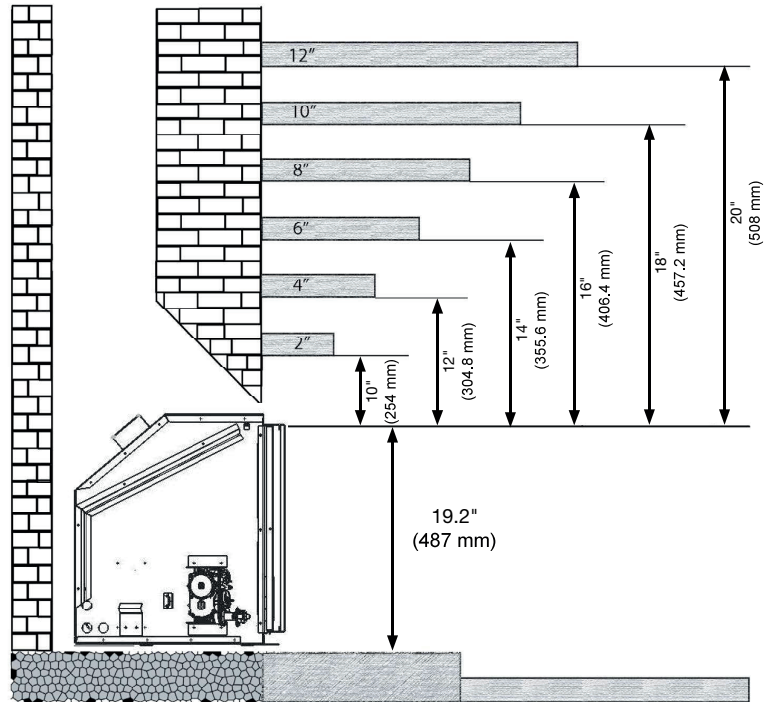

### Sidewall Clearances

Maintain a minimum of 7" (178 mm) clearance from the side of the door to sidewalls or mantel supports.

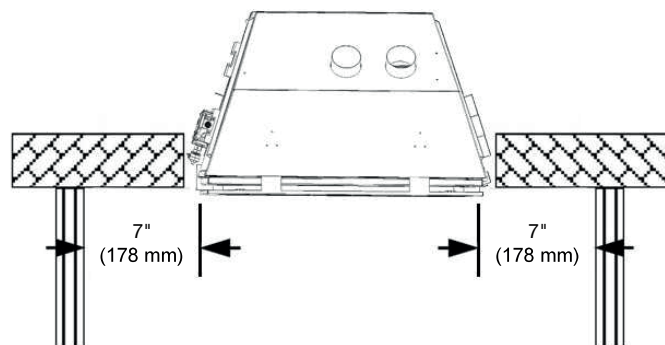

## Model: Inspiration® 29

### Hearth Clearances

Any hearth that extends outward in front of the insert must not have any combustible material closer than 3" (76.2 mm) to the bottom of the gas fireplace insert regardless of whether a noncombustible material covers the combustible material. This includes any type of framing underneath a noncombustible material such as tile, marble, or stone. Any material farther than 3" (76.2 mm) to the bottom or 16" (406.4 mm) from the front of the door of the gas fireplace insert can be combustible.

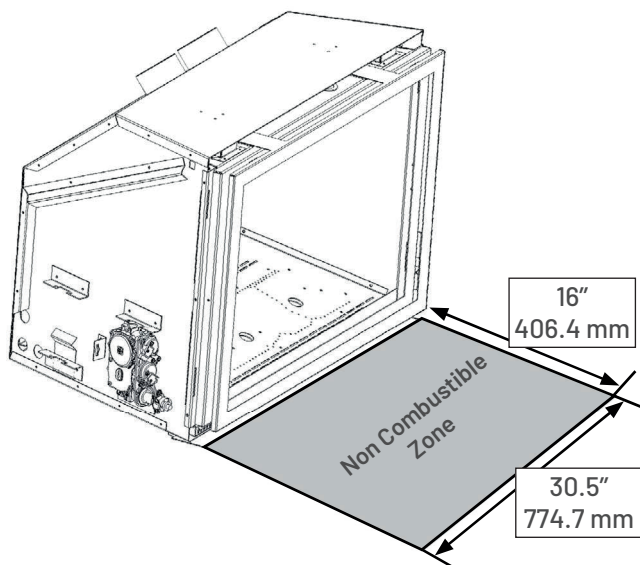

**Note:** All specified clearances must be maintained from the top surface of carpeting, tile, etc.

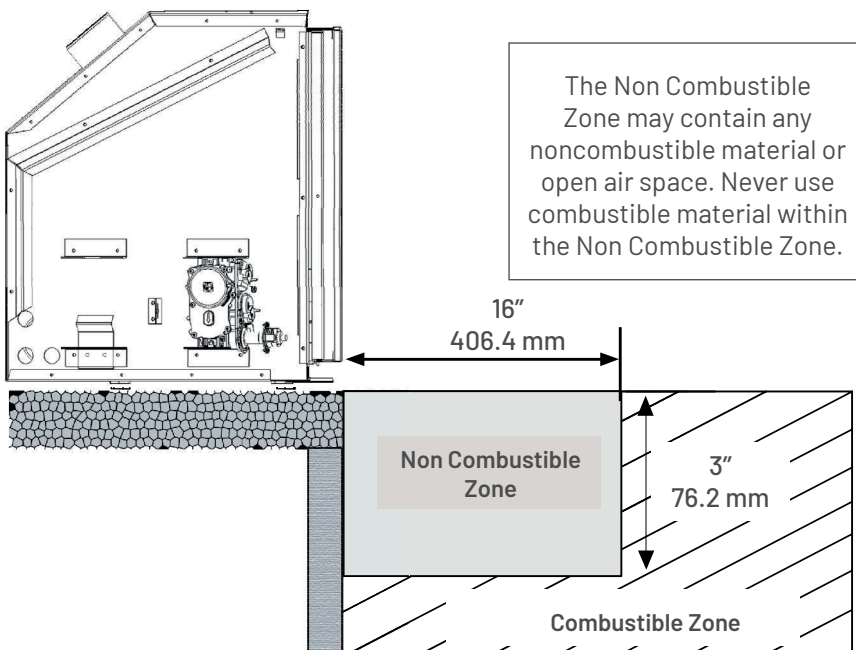

## Model: Inspiration® 29

### Min/Max Vent Run

**Instruction for installing venting and terminations (see list for approved venting and terminations).**

**Install The termination cap being sure to provide sufficient space (around and on top) so you do not impede the flow of air both into and out of the cap. This cap is only to be used for non combustible installations. Do not recess into the top of the chimney.**

1. Mark each end of one flex liner with «Air intake».
2. Mark each end of the second flex liner with «Exhaust».
3. Pull the liner through the chimney.
4. Install the flashing.
5. Seal and attach the flex liner marked «Air Intake» to the vent terminal pipe marked «Air Intake» as per terminal manufacturers instruction. **DO NOT USE SILICONE.**
6. Seal and attach the flex liner marked «Exhaust» to the vent terminal pipe marked «Exhaust» as per terminal manufacturers instruction. **DO NOT USE SILICONE.**
7. Seal and attach the end of the flex liner marked «Air Intake» to the collar marked «Air Intake» on the appliance with the collar clamp provided with the unit. **DO NOT USE SILICONE.**
8. Seal and attach the end of the flex liner marked «Exhaust» to the collar marked «Exhaust» on the appliance with the collar clamp provided with the unit. **DO NOT USE SILICONE.**
9. Caulk all joints using a high temperature sealant such as Mil-Pac®. **DO NOT USE SILICONE. Use of silicone sealants voids the warranty of the pilot assembly.**

**NOTE :** The flex liners must form a complete connection from the appliance flue collars to the vertical termination cap.

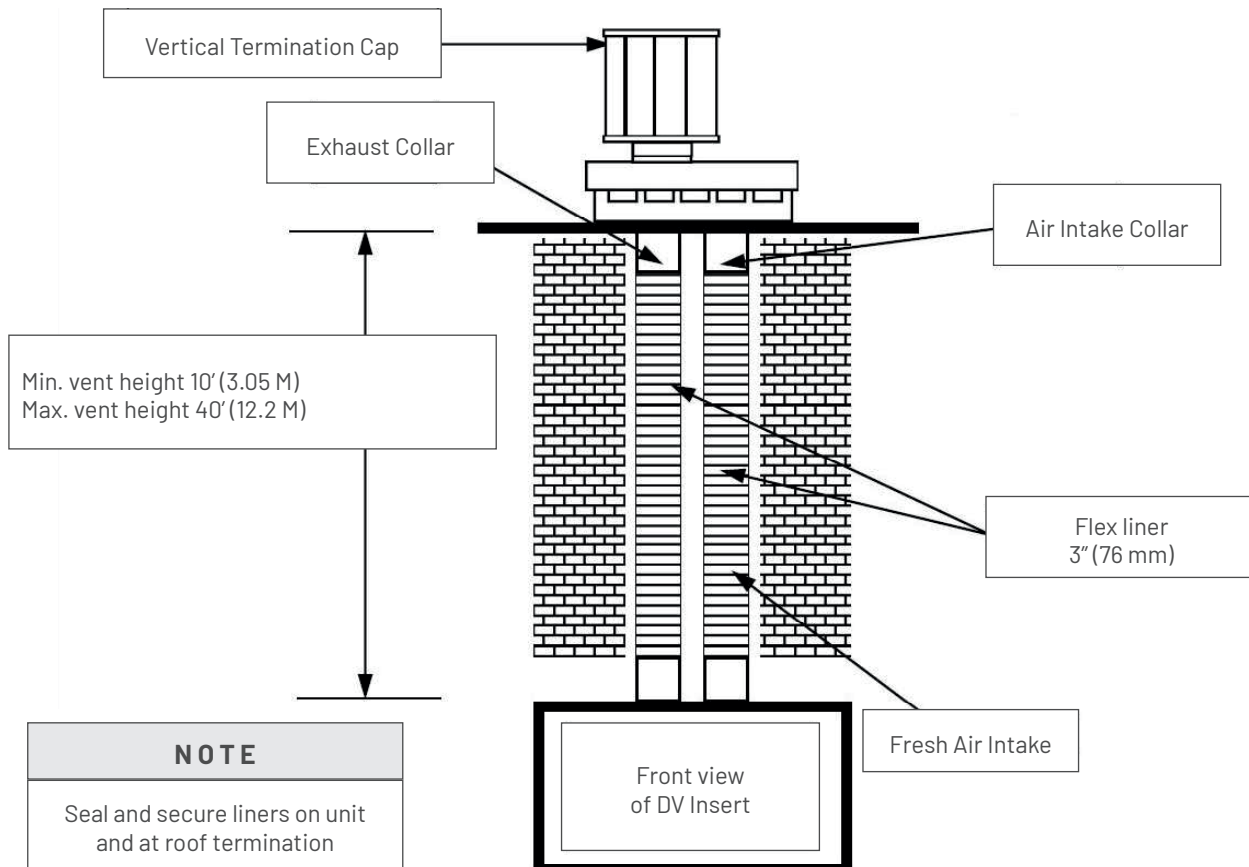

The minimum flue (chimney) size required to run the two 3" (76 mm) is 4" x 7" (100 mm x 178 mm).